



# PAVILION & HOSPITAL

FLOOR

# 1



**P**

Pavilion Parking Garage Level 1 (Purple)

**Complimentary Valet Parking**  
Open Monday-Friday  
6 a.m.-8 p.m.



**Seasons Café**

Monday-Friday  
6:15 a.m.-7:30 p.m.

**Riverbend Grille**

**Riverbend Grille**

Open 7 days/week  
Breakfast: 6-10 a.m. (M-F) and 7:30-10 a.m. (weekends)  
Lunch & Dinner: 10:30 a.m.-2:30 p.m., 3-8 p.m.  
Guest meals available



# PAVILION & HOSPITAL

FLOOR

# 2

**P**

Pavilion  
Parking Garage  
Level 2 (Green)



**P** Parking Garage

# HOSPITAL

FLOOR

# 3

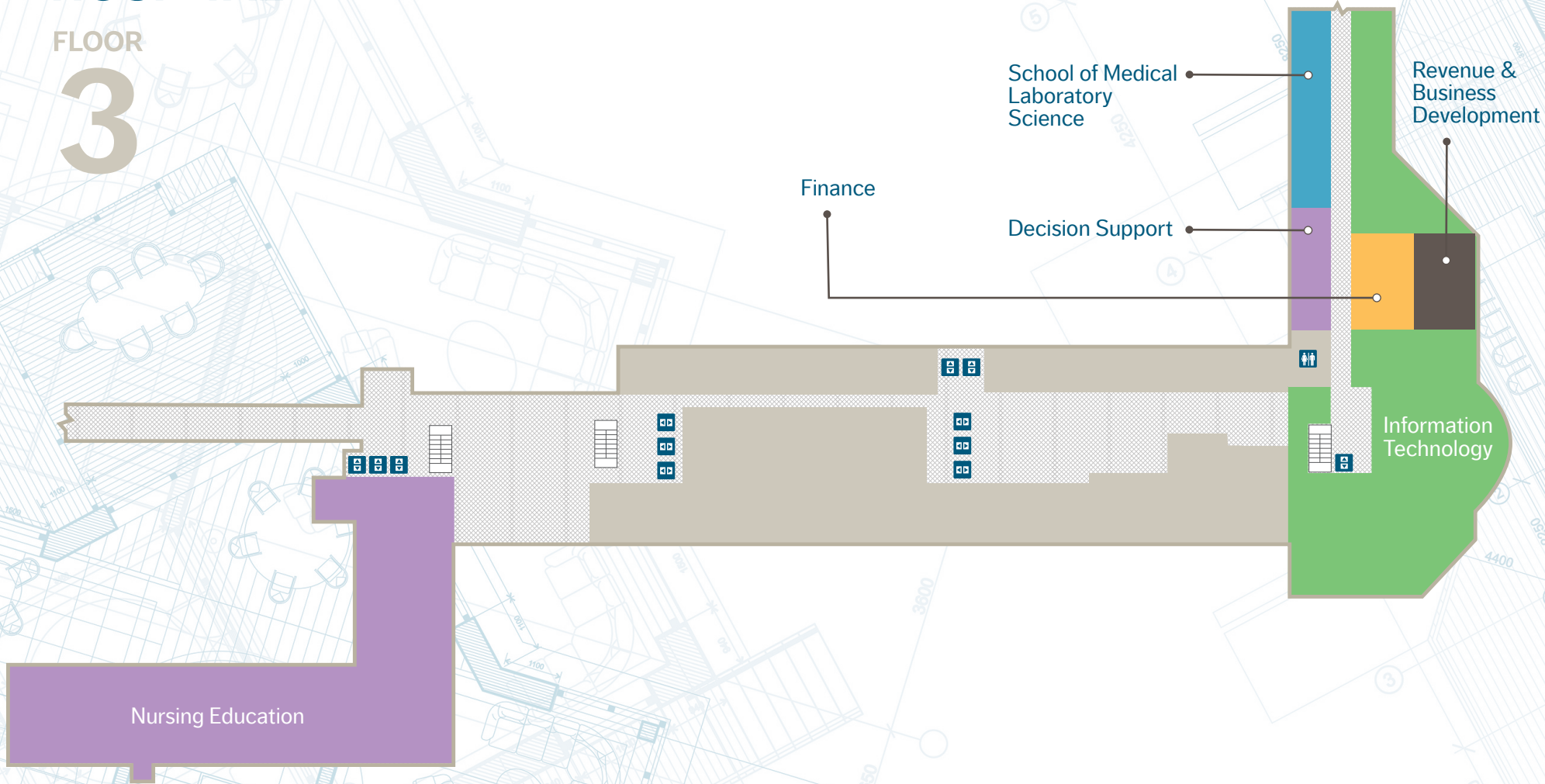



# HOSPITAL Acute Rehabilitation

FLOOR

# 4



Walkway  
To Pavilion  
(4th Floor)

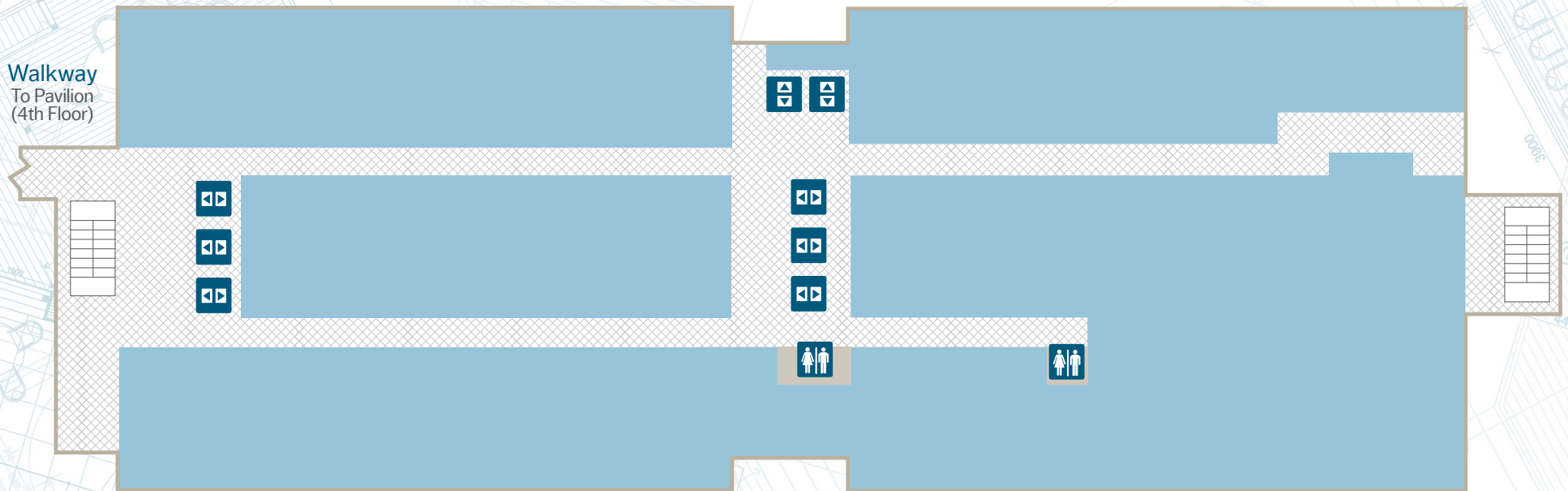

# HOSPITAL Oncology

FLOOR

# 5



Walkway  
To Pavilion  
(5th Floor)

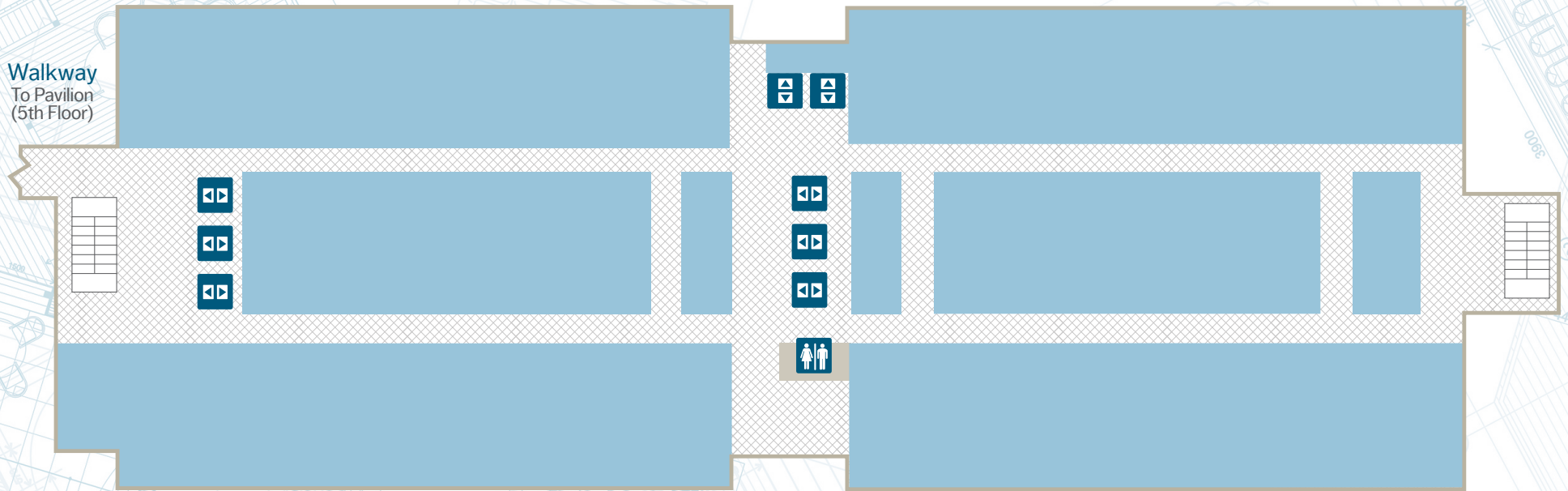





# HOSPITAL Progressive Care

FLOOR

# 6

Walkway  
To Pavilion  
(6th Floor)

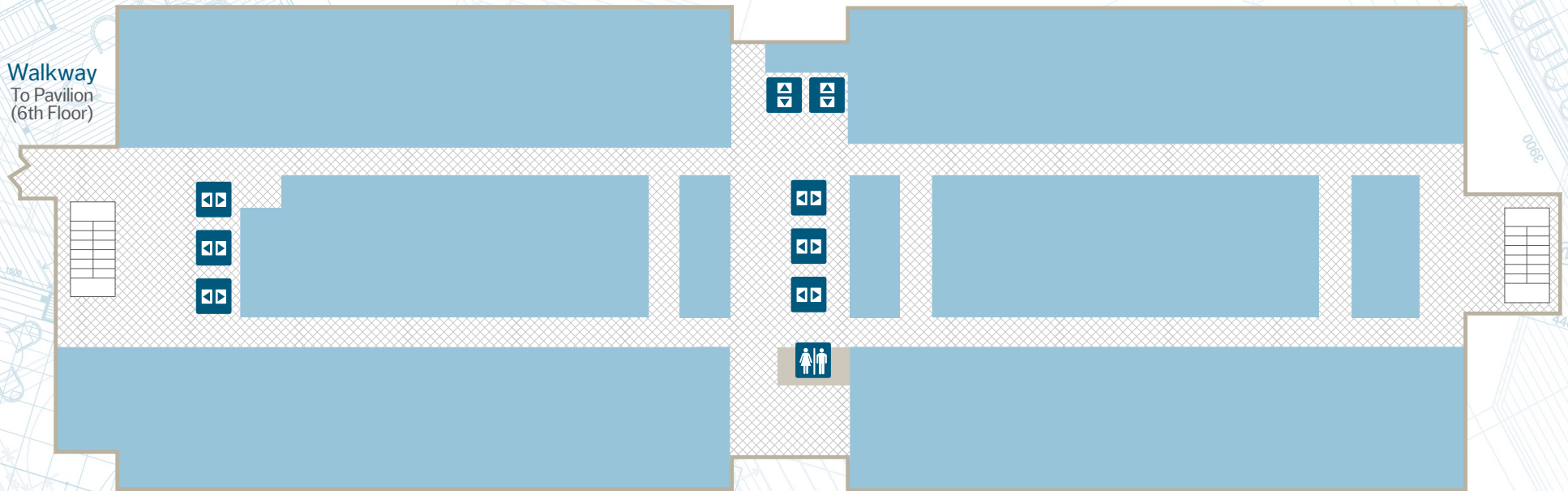

# HOSPITAL Labor/Delivery/NICU

FLOOR

# 7



Walkway  
To Pavilion  
(7th Floor)

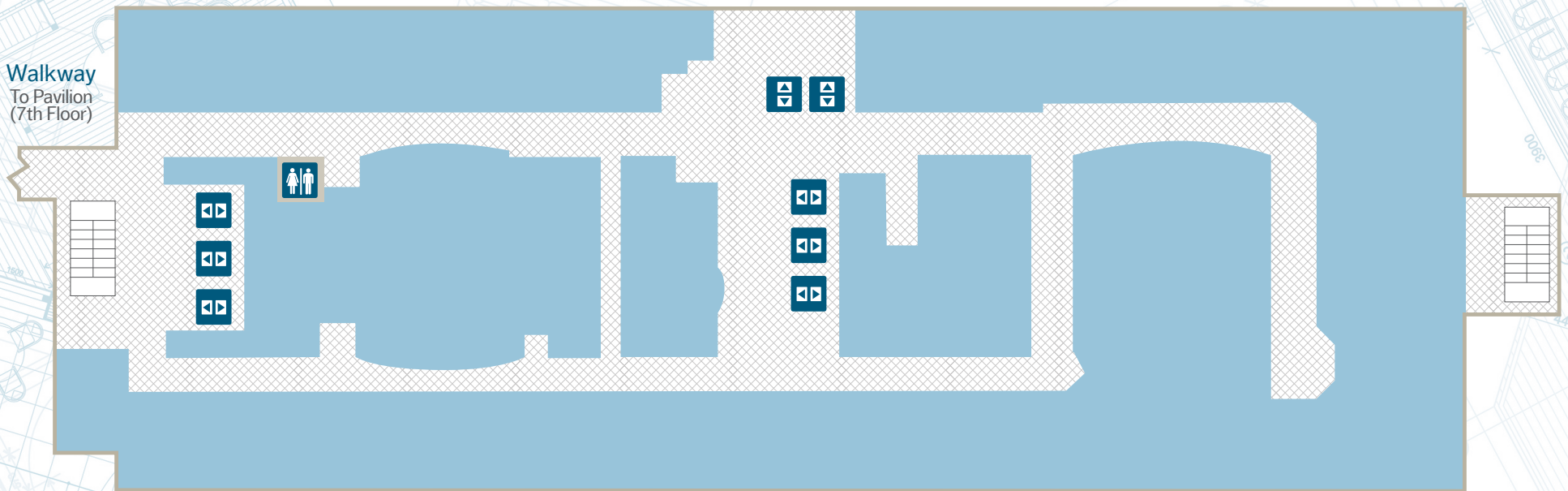



# HOSPITAL Maternal Child Health

FLOOR

# 8



Walkway  
To Pavilion  
(8th Floor)

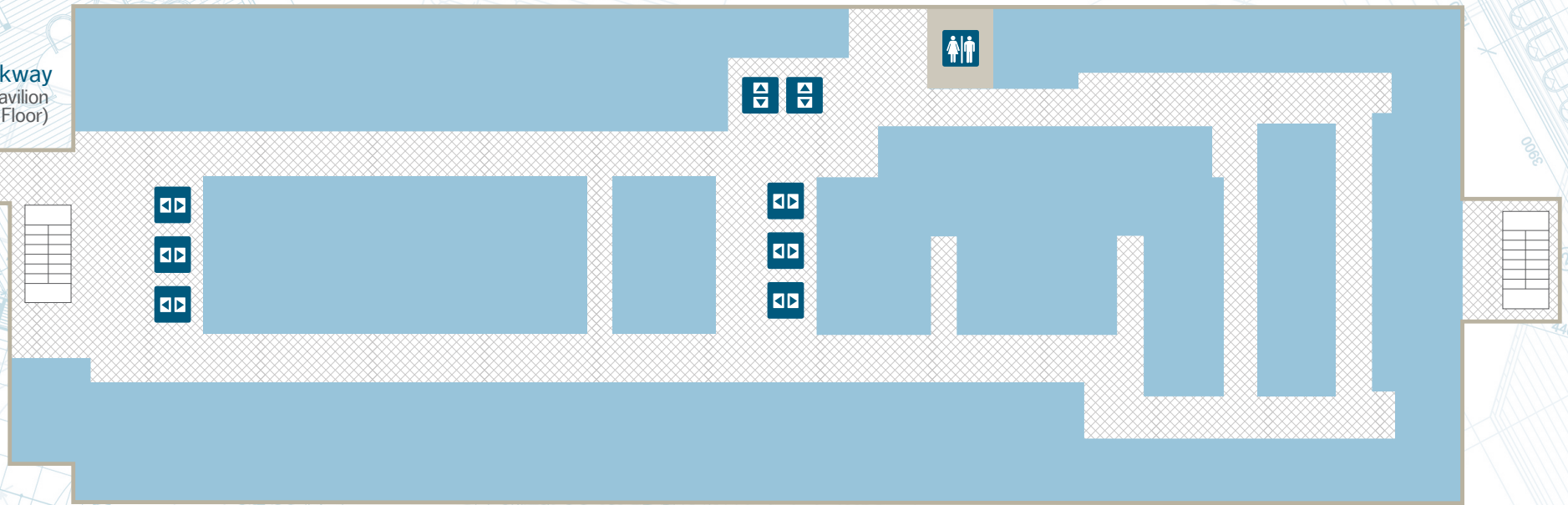



# HOSPITAL Acute Rehabilitation/CICU

FLOOR

# 9



Walkway  
To Pavilion  
(9th Floor)

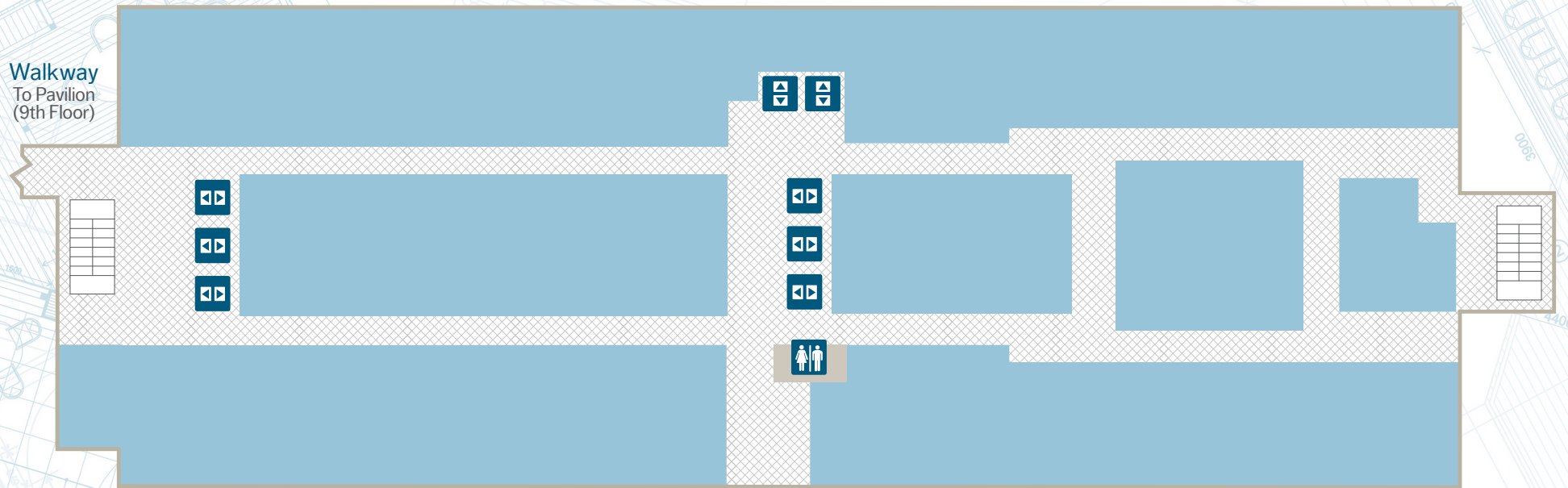

# HOSPITAL Special Use

FLOOR

# 10



Walkway  
To Pavilion  
(10th Floor)

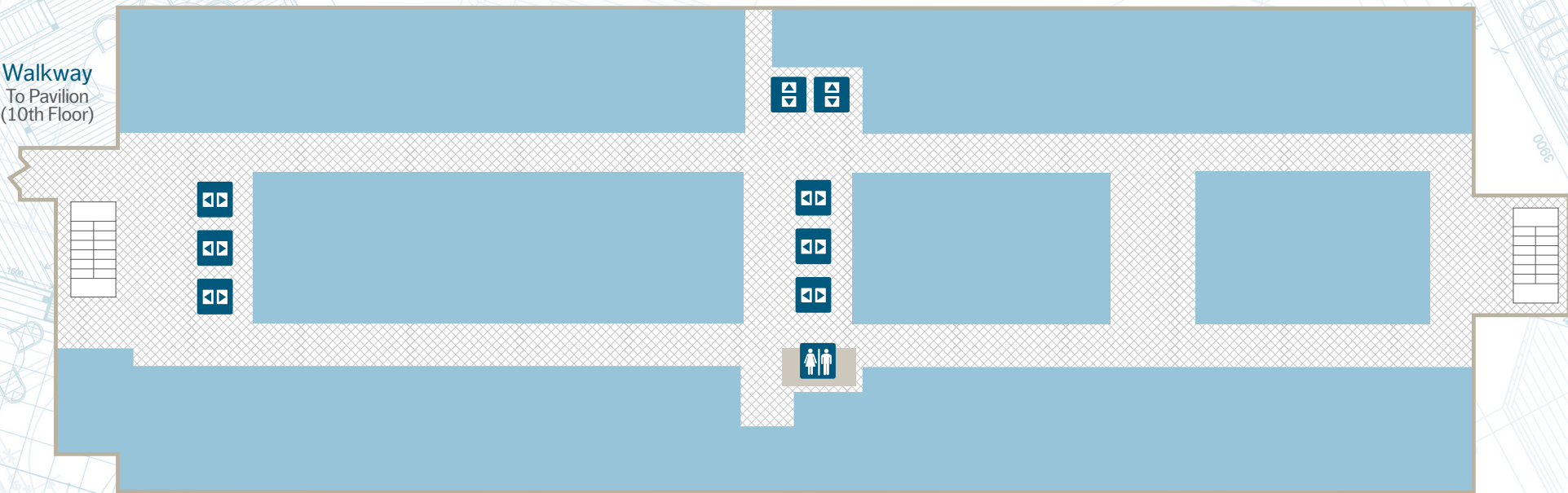





# HOSPITAL Renal/Telemetry

FLOOR

# 11

Walkway  
To Pavilion  
(10th Floor)

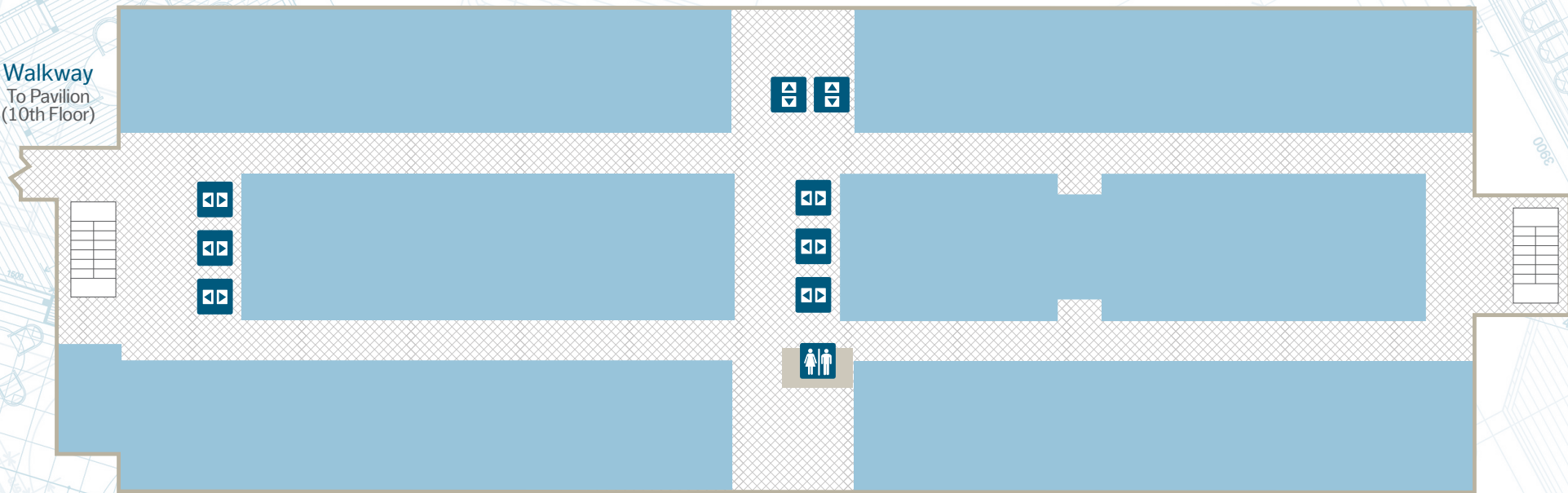





# HOSPITAL Skyview Conference Room

FLOOR

# 12

Skyview Conference Room

